

CRUISE CONTROL MAIN SWITCH

COMPONENTS

CC

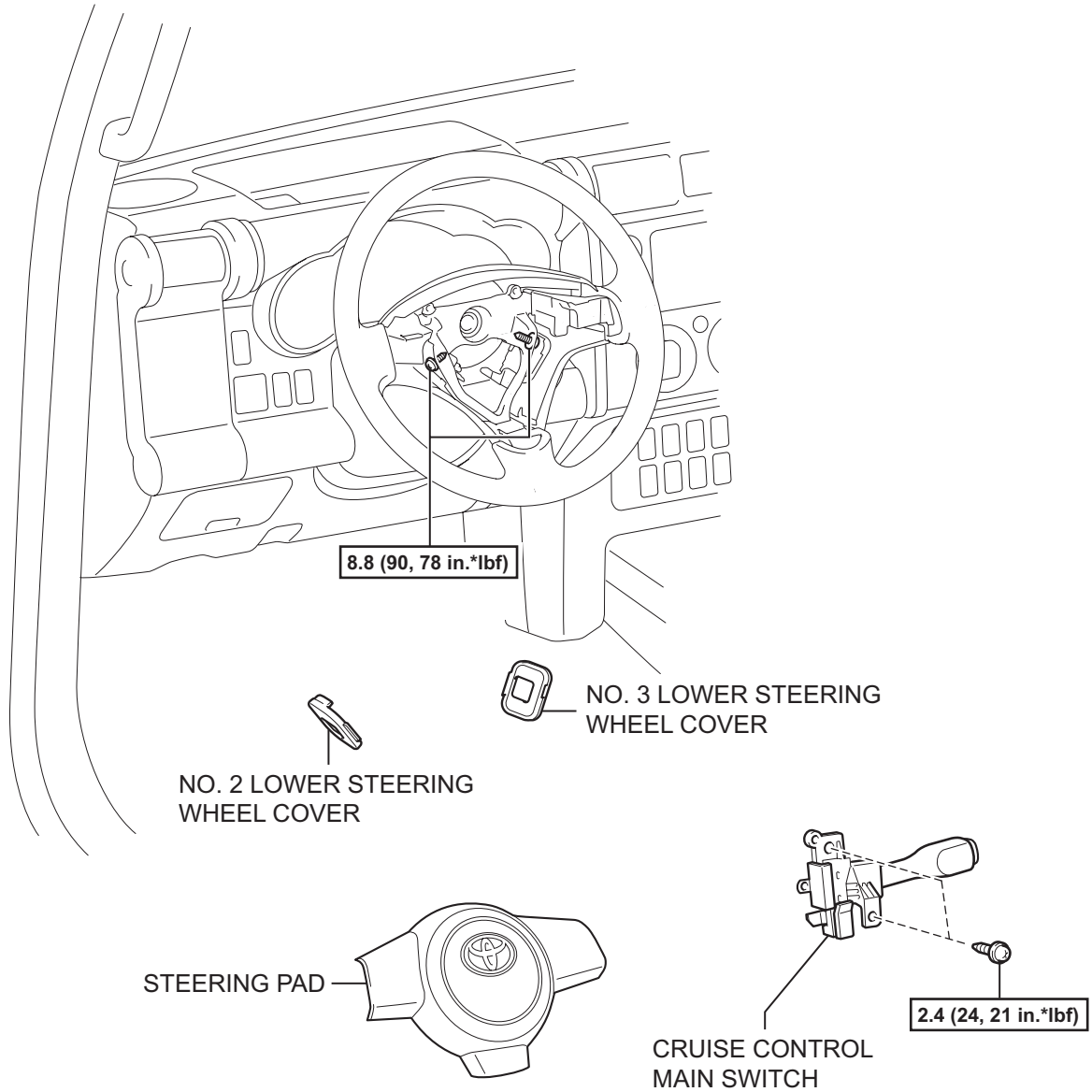

N*m (kgf*cm, ft*lbf) : Specified torque

REMOVAL

CAUTION:

Some of these service operations affect the SRS airbag system. Read the precautionary notices concerning the SRS airbag system before servicing (See page [RS-1](#)).

1. **DISCONNECT CABLE FROM NEGATIVE BATTERY TERMINAL**

Wait for at least 90 seconds after disconnecting the cable to prevent the airbag from working.

2. **REMOVE NO. 2 LOWER STEERING WHEEL COVER**
(See page [RS-345](#))

3. **REMOVE NO. 3 LOWER STEERING WHEEL COVER**
(See page [RS-345](#))

4. **REMOVE STEERING PAD** (See page [RS-346](#))

5. **REMOVE CRUISE CONTROL MAIN SWITCH**

- (a) Disconnect the connector.
- (b) Remove the 2 screws and remove the cruise control main switch.

